

Take and Make: Pet Leash Holder

Inventory: 1 plaque, 1 J-hook, 2 sawtooth hangers, 6 small screws, 2 command strips, & 2 paw print stickers

Please have the following on hand for completing the program: 1 screwdriver, glue, and additional decorative materials as desired (sharpie, paint, collage material, etc.)

Instructions:

1. Line up the J-hook with the two holes in the center of the front of the plaque.
2. Screw the hook to the plaque with a screwdriver or drill. Be careful while installing screws as the wood is easy to crack.

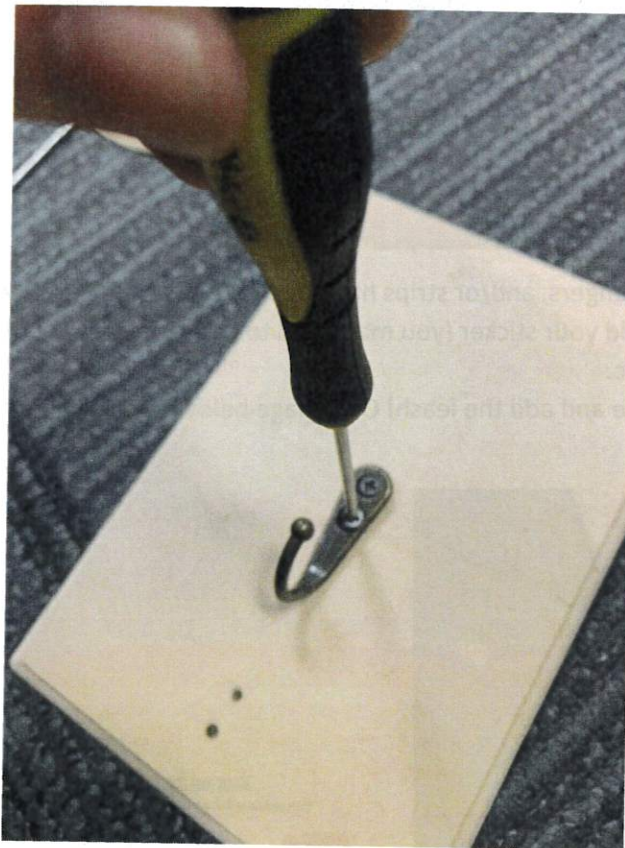

3. On the back, either screw the sawtooth hangers to the holes or mark where you would like to have command strips placed.
 - a. If you can use the hangers, that is recommended as it will give longevity to the project. Otherwise, keep the sawtooth hangers for when you can install them.

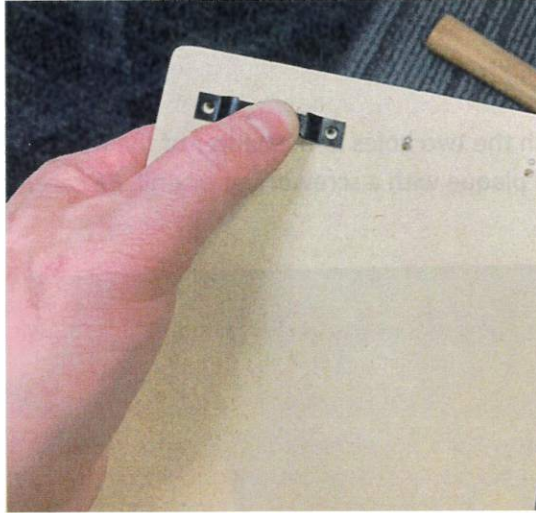

4. Once the hooks, hangers, and/or strips have been installed, time to decorate your pet leash holder! You can add your sticker (you may need to glue it- we had to glue ours), write a message, paint, etc.
5. Hang it somewhere and add the leash! Our image below reads: Unleash your Joy, and the “y” is made into a dog.



Tag us so we can see your completed project!

Visit ppld.org for more information about programming, and check out our social media below!



Like and Subscribe to us on YouTube at PPLDTV



@PikesPeakLibraryDistrict



@ppld on Twitter



@PikesPeakLibraryDistrict

